



## POWDER BOOTHS

# Conveyorized and Batch Booths

Rohner conveyorized and batch powder booths are designed with optimal airflow for powder containment and application efficiency. Rohner offers several standard sizes and expandable configurations to meet your batch and high production powder coat needs.



Rohner Conveyorized and Batch Powder Booths are a great way to bring the advantages of a reclaim/spray-to-waste cartridge collector efficiency to your process. Standard Rohner Powder Booths control air uniformly through all booth openings, exhausting air and collecting excess powder through the two-stage filters of the collector module(s) on the outside of the booth.

**Customization:** Catalog standard Rohner Conveyorized and Batch Powder Booths are easily customized to achieve any size required. Rohner's integral booth structure can be engineered to support conveyor loads and create large spans. Collector modules can be outfitted with fluidized reclaim hoppers and transfer pumps. Rohner Powder Booths can also incorporate standard product doors, operator openings, part openings, conveyor slots and automatic gun slots. Choose any combination of Rohner's customizable options to suit your coating needs.

**Components:** Rohner uses spark resistant direct-drive blowers with TEFC motors for collector modules. All Rohner modules come with electric/pneumatic back-pulse cleaning solenoids with manifold. All Rohner booths utilize UL listed 4-tube 4'-0" light fixtures and color-true T8 tubes are included as standard. Optional UL listed NEMA 12 industrial control panel with automatic pressure sensing timer board, motor and lighting controls are recommended.

### APPLICATIONS

Rohner Conveyorized and Batch Powder Booths provide a superior application environment for large production or small job shop runs and can be designed for automatic or manual gun production.

Rohner Conveyorized and Batch Powder Booths offer customizable airflow for multiple part and process configurations. Batch Powder Booths are an ideal option for job shops and powder coaters.

Rohner Conveyorized and Batch Powder Booths are designed with air flow in excess of 100' per/min. and are designed to meet NFPA 33 and OSHA 29 CFR 1910.107 (refer to local codes for additional requirements.)

Tel: 360.885.7641

Fax: 360.896.5748

2650 NE Andresen Rd. #102

Vancouver, WA 98661

info@rohner-usa.com

www.rohner-usa.com

**Construction:** Rohner Conveyorized Powder Booths are constructed with stainless steel 18ga. sheet panels, polycarbonate ceiling panels and heavy gauge powder coated galvanized steel structure. Rohner Batch Powder Booth are constructed using white powder coated 18 ga. galvanized sheet steel.

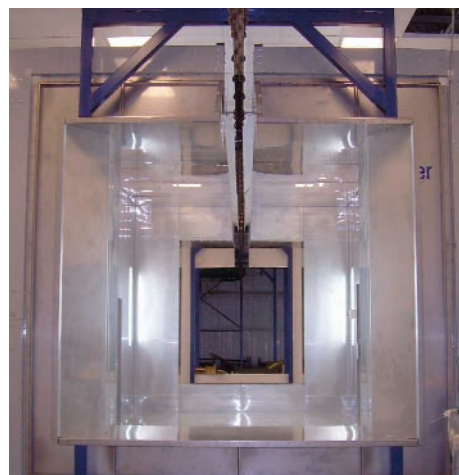

### FEATURES

- Multiple standard sizes
- 3.5K, 4.5K, 6K, 8K, 10K, & 12K CFM standard
- Cartridge collector modules with final filtration
- Stainless, Powder Coated, and Polycarbonate Construction
  - Precision-punched, nut and bolt construction
- Direct drive exhaust blower
- Adjustable Volume Damper
- UL Listed High Efficiency T-8 Fluorescent light fixtures and lamps
  - 1 Year Warranty

From performance to reliability and process control, Rohner Heated MAU's are designed to meet your most demanding finishing and refinishing requirements.

## CONVEYORIZED BOOTHS

Booth #	Width- (W.D.)	Height- (W.D.)	Depth- (W.D.)	Width- (O.D.)	Height- (O.D.)	Depth- (O.D.)	Standard Fixtures	Class I, Div. II	Hinged Closure Panels Y/N	Opening Size	Collector Module Qty./cfm
<b>2'-0" X 4'-0" Part Opening</b>											
CPB-2-4	7'-6"	7'-10"	8'-0"	7'-10"	8'-4"	11'-0"	2	0	N	7'-6"x7'-10"	(1) 7.5hp- 6000cfm
<b>3'-0" X 5'-0" Part Opening</b>											
CPB-3-5	9'-6"	7'-10"	8'-0"	9'-10"	8'-4"	11'-0"	1	0	Y	7'-6"x7'-10"	(1) 7.5hp- 6000cfm
<b>4'-0" X 6'-0" Part Opening</b>											
CPB-4-6	11'-6"	7'-10"	8'-0"	11'-10"	8'-4"	11'-2"	1	0	N	11'-6"x7'-10"	(2) 5hp- 4500cfm

## BATCH BOOTHS

Booth #	Width- (W.D.)	Height- (W.D.)	Depth- (W.D.)	Width- (O.D.)	Height- (O.D.)	Depth- (O.D.)	Standard Fixtures	Class I, Div. II	Hinged Clo- sure Panels Y/N	Opening Size	Collector Module Qty./cfm
<b>8'-0" Wide</b>											
BPB-CM6000-8-8-8	7'-6"	7'-10"	8'-0"	7'-10"	8'-4"	11'-0"	2	0	N	7'-6"x7'-10"	(1) 7.5hp- 6000cfm
BPB-CM6000-8-8-11	7'-6"	7'-10"	10'-6"	7'-10"	8'-4"	13'-6"	1	0	N	7'-6"x7'-10"	(1) 7.5hp- 6000cfm
BPB-CM6000-8-8-13	7'-6"	7'-10"	13'-0"	7'-10"	8'-4"	15'-0"	2	0	N	7'-6"x7'-10"	(1) 7.5hp- 6000cfm
BPB-CM6000-8-8-16	7'-6"	7'-10"	15'-6"	7'-10"	8'-4"	18'-6"	2	0	N	7'-6"x7'-10"	(1) 7.5hp- 6000cfm
<b>10'-0" Wide</b>											
BPB-CM6000-10-8-8	9'-6"	7'-10"	8'-0"	9'-10"	8'-4"	11'-0"	1	0	Y	7'-6"x7'-10"	(1) 7.5hp- 6000cfm
BPB-CM6000-10-8-11	9'-6"	7'-10"	10'-6"	9'-10"	8'-4"	13'-6"	2	0	Y	7'-6"x7'-10"	(1) 7.5hp- 6000cfm
BPB-CM6000-10-8-13	9'-6"	7'-10"	13'-0"	9'-10"	8'-4"	15'-0"	2	0	Y	7'-6"x7'-10"	(1) 7.5hp- 6000cfm
BPB-CM6000-10-8-16	9'-6"	7'-10"	15'-6"	9'-10"	8'-4"	18'-6"	3	0	Y	7'-6"x7'-10"	(1) 7.5hp- 6000cfm
BPB-2CM3500-10-10-8	9'-6"	9'-10"	8'-0"	15'-6"	10'-4"	11'-2"	2	0	Y	7'-6"x9'-10"	(2) 5hp- 3500cfm
BPB-2CM3500-10-10-11	9'-6"	9'-10"	10'-6"	15'-6"	10'-4"	13'-8"	2	0	Y	7'-6"x9'-10"	(2) 5hp- 3500cfm
BPB-2CM3500-10-10-13	9'-6"	9'-10"	13'-0"	15'-6"	10'-4"	16'-2"	3	0	Y	7'-6"x9'-10"	(2) 5hp- 3500cfm
BPB-2CM3500-10-10-16	9'-6"	9'-10"	15'-6"	15'-6"	10'-4"	18'-8"	4	0	Y	7'-6"x9'-10"	(2) 5hp- 3500cfm
<b>12'-0" Wide</b>											
BPB-2CM4500-12-8-8	11'-6"	7'-10"	8'-0"	11'-10"	8'-4"	11'-2"	1	0	N	11'-6"x7'-10"	(2) 5hp- 4500cfm
BPB-2CM4500-12-8-11	11'-6"	7'-10"	10'-6"	11'-10"	8'-4"	13'-8"	2	0	N	11'-6"x7'-10"	(2) 5hp- 4500cfm
BPB-2CM4500-12-8-13	11'-6"	7'-10"	13'-0"	11'-10"	8'-4"	16'-2"	3	0	N	11'-6"x7'-10"	(2) 5hp- 4500cfm
BPB-2CM4500-12-8-16	11'-6"	7'-10"	15'-6"	11'-10"	8'-4"	18'-8"	3	0	N	11'-6"x7'-10"	(2) 5hp- 4500cfm
BPB-2CM4500-12-10-8	11'-6"	9'-10"	8'-0"	11'-10"	10'-4"	11'-2"	2	0	Y	9'-0"x9'-10"	(2) 5hp- 4500cfm
BPB-2CM4500-12-10-11	11'-6"	9'-10"	10'-6"	11'-10"	10'-4"	13'-8"	3	0	Y	9'-0"x9'-10"	(2) 5hp- 4500cfm
BPB-2CM4500-12-10-13	11'-6"	9'-10"	13'-0"	11'-10"	10'-4"	16'-2"	3	0	Y	9'-0"x9'-10"	(2) 5hp- 4500cfm
BPB-2CM4500-12-10-16	11'-6"	9'-10"	15'-6"	11'-10"	10'-4"	18'-8"	4	0	Y	9'-0"x9'-10"	(2) 5hp- 4500cfm
BPB-2CM6000-12-12-13	11'-6"	11'-10"	12'-6"	11'-10"	12'-4"	16'-8"	3	2	Y	10'-0"x11'-10"	(2) 7.5hp- 6000cfm
BPB-2CM6000-12-12-16	11'-6"	11'-10"	15'-6"	11'-10"	14'-4"	18'-8"	3	2	Y	10'-0"x11'-10"	(2) 7.5hp- 6000cfm

### Design Notes:

1. Use Total Static Pressure column that will overcome total system resistance. Approximate pressure drop for components and accessory items; burner 1/2", Filter (dirty) 1/4", intake hood 1/8", birdscreen 1/8", discharge louver 1/8". Damper resistance may be ignored.
2. NA = Not Available. CRO = Contact Rohner Office

## COLLECTOR MODULES

Module Type	Width- (O.D.)	Height- (O.D.)	Depth- (O.D.)	Cartridge Filters Size/ Qty.	Final Filters Size/ Qty.
<b>3,500 CFM (FRB= Fluidized Recovery Bed)</b>					
CM-3500	5'-0"	8'-0"	3'-0"	12.75"Dx26"/6	24"x24"x4"/3
CM-3500-FRB	5'-0"	8'-0"	3'-0"	12.75"Dx26"/6	24"x24"x4"/3
<b>4,500 CFM</b>					
CM-4500	5'-0"	8'-0"	3'-0"	12.75"Dx26"/6	24"x24"x4"/3
CM-4500-FRB	5'-0"	8'-0"	3'-0"	12.75"Dx26"/6	24"x24"x4"/3
<b>6,000 CFM</b>					
CM-6000	5'-0"	8'-0"	3'-0"	12.75"Dx26"/6	24"x24"x4"/4
CM-6000-FRB	5'-0"	8'-0"	3'-0"	12.75"Dx26"/6	24"x24"x4"/4
<b>8,000 CFM</b>					
CM-8000	5'-0"	8'-0"	3'-0"	12.75"Dx26"/6	24"x24"x4"/4
CM-8000-FRB	5'-0"	8'-0"	3'-0"	12.75"Dx26"/6	24"x24"x4"/4
<b>10,000 CFM</b>					
CM-10000	5'-0"	8'-0"	3'-0"	12.75"Dx26"/6	24"x24"x4"/6
CM-10000-FRB	5'-0"	8'-0"	3'-0"	12.75"Dx26"/6	24"x24"x4"/6
<b>12,000 CFM</b>					
CM-12000	5'-0"	8'-0"	3'-0"	13.75"Dx26"/6	24"x24"x4"/8
CM-12000-FRB	5'-0"	8'-0"	3'-0"	13.75"Dx26"/6	24"x24"x4"/8

## POWDER BOOTH CONTROL PANELS

Control Panel Type	Motor Voltage	Motor Phase	Qty. Exhaust Motors	HP Each Exhaust Motor	Exhaust (VFD, MS)	Qty. Blower Supply Motors	HP Blower Supply	Blower (SS, VFD, MS)	Qty. Lighting Contactor	Lighting Contactor Max Amprage	Pressure Control Type	Enclosure Size
<b>460 Volt 3-Phase Without Fluidized Recovery Bed</b>												
SPBCP-460V3-1CM(5-7.5)-LC20	460	3	1	5-7.5	MS	CRO	CRO	CRO	1LC	20	CRO	24 x 24 x 10
SPBCP-460V3-2CM(5-7.5)-LC20	460	3	2	5-7.5	MS	CRO	CRO	CRO	1LC	20	CRO	24 x 24 x 10
<b>230 Volt 3-Phase Without Fluidized Recovery Bed</b>												
SPBCP-230V3-1CM(5-7.5)-LC20	230	3	1	5-7.5	MS	CRO	CRO	CRO	1LC	20	CRO	24 x 24 x 10
SPBCP-230V3-2CM(5-7.5)-LC20	230	3	2	5-7.5	MS	CRO	CRO	CRO	1LC	20	CRO	24 x 24 x 10
<b>460 Volt 3-Phase With Fluidized Recovery Bed</b>												
SAPBCP-460V3-1CM(10-15)-LC20	460	3	1	10-15	MS	CRO	CRO	CRO	1LC	20	CRO	30 x 30 x 12
SAPBCP-460V3-2CM(10-15)-LC20	460	3	2	10-15	MS	CRO	CRO	CRO	1LC	20	CRO	30 x 30 x 12
<b>230 Volt 3-Phase With Fluidized Recovery Bed</b>												
SAPBCP-230V3-1CM(10-15)-LC20	230	3	1	10-15	MS	CRO	CRO	CRO	1LC	20	CRO	30 x 30 x 12
SAPBCP-230V3-2CM(10-15)-LC20	230	3	2	10-15	MS	CRO	CRO	CRO	1LC	20	CRO	30 x 30 x 12

# CONVEYORIZED POWDER BOOTHS

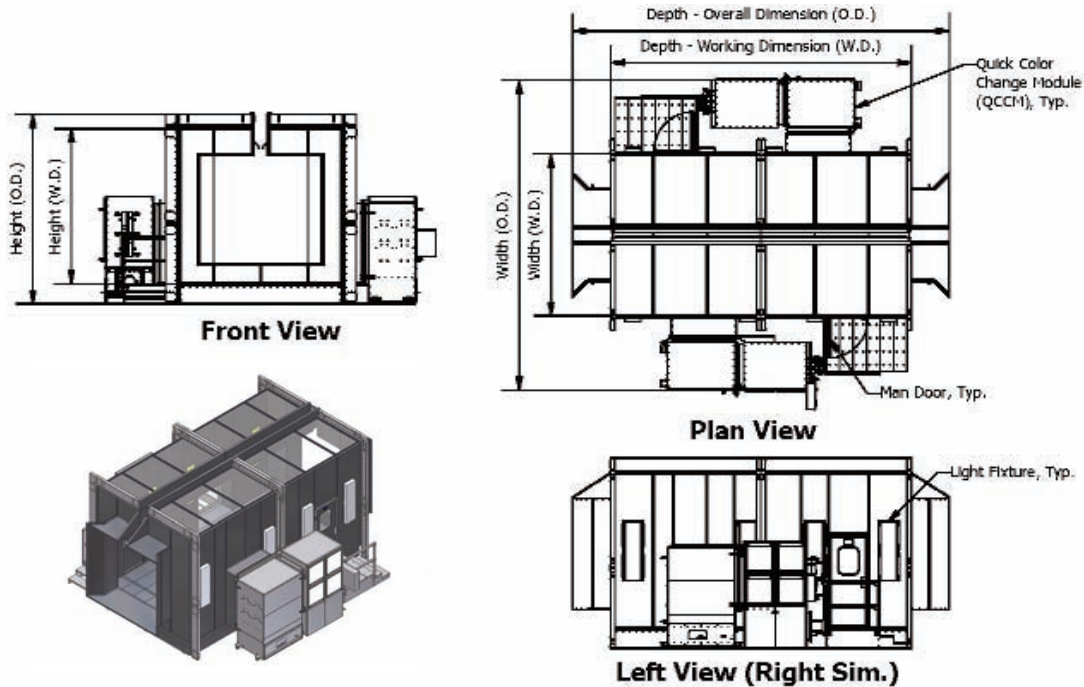

# BATCH POWDER BOOTHS

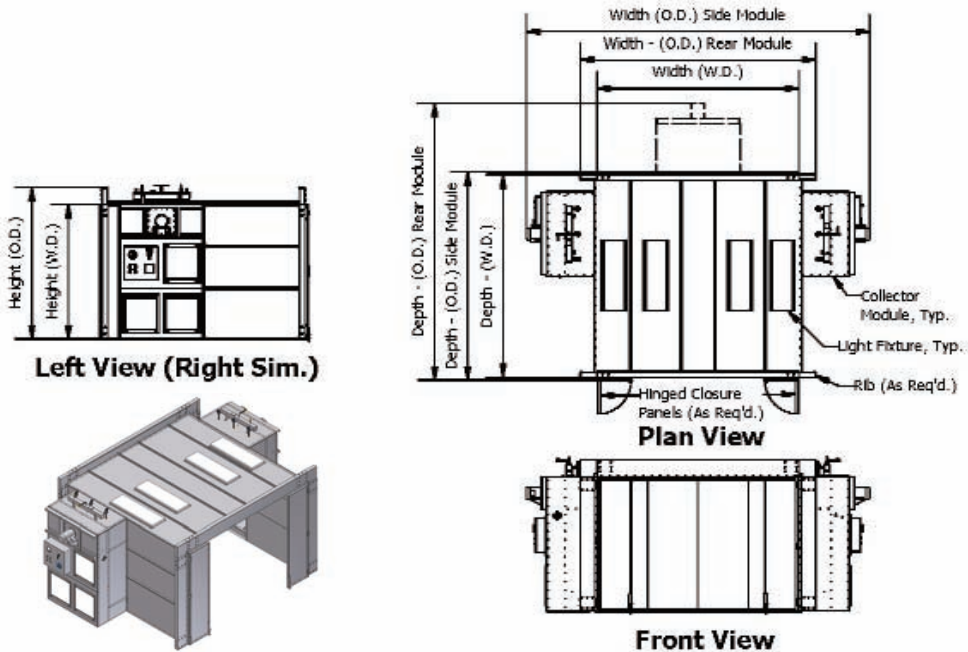

## STANDARD OPTIONS

- UL Control Panel
- Fluidized reclaim hopper
- Filtered Product doors
- Conveyor & part openings
- Operator openings
- Auto gun slots
- Seismic engineering
- On/Off line booth platform

## CUSTOMIZABLE OPTIONS

- Conveyor support structure
- Fire detection
- Hopper, sieve and reclaim controls
- ETL field evaluated label
- Conveyor shroud
- Coiling rollup doors
- HEPA final filtration